

ARCHITECTURAL GRATES + DRAINS



65AAG25

Linear Drain

Stormtech is the only linear drainage system available with full Greentag and Watermark certification across our complete product range.

Telephone 01483 346460 | Web slimlinedrain.co.uk





ARCHITECTURAL
GRATES + DRAINS



65AAG25

Linear Drain



The iconic wave grate, now available in a new slim 65 x 25mm profile

Modular linear drainage kit featuring low carbon anodized aluminium grate and certified Best Environmental Practice uPVC channel and fittings. Designed for simple self assembly on site.

Kits longer than 3000mm are available on request.

Code 65AAG25

Range 65

Grate Style AA

Category Modular Kits

Channel Material uPVC

STORMTECH COLOUR FINISHES



Aluminium

Electroplate finishes subject to natural variation with time and local environment. Factors such as pools/surf beaches may require electropolishing. Contact us for suitability.

PRODUCT APPLICATIONS

Bathroom Drainage
Aged / Health Care Drainage
Balcony Drainage
Commercial Drainage
Courtyard / Patio Drainage
Pool and Spa Area Drainage

Hospitality Drainage
Paved Area Drainage
Shower Drainage
Multi-Residential Drainage
Special Needs Drainage
Threshold Drainage



Grates longer than 1500mm supplied in sections. Tile Inserts longer than 1200mm supplied in sections. Channels over 3000mm supplied in sections with joiner. +/-2mm tolerance on dimensions.

Copyright © Stormtech Pty Ltd. Patent 733361. Drawings not to scale, please use dimensions shown.
Downloaded 19/02/2026 (please check for updates)



Visit slimlinedrain.co.uk
for tools + inspiration.

Phone 01483 346460

Email technical@slimlinedrain.co.uk

65G25 Assembly

For 65ARG25, 65MNDG25, 65PHG25, 65PSG25, 65TRG25, and 65TRTiG25.



The PDB support fits under the cut grate to support tynes of the grate (65PS only).

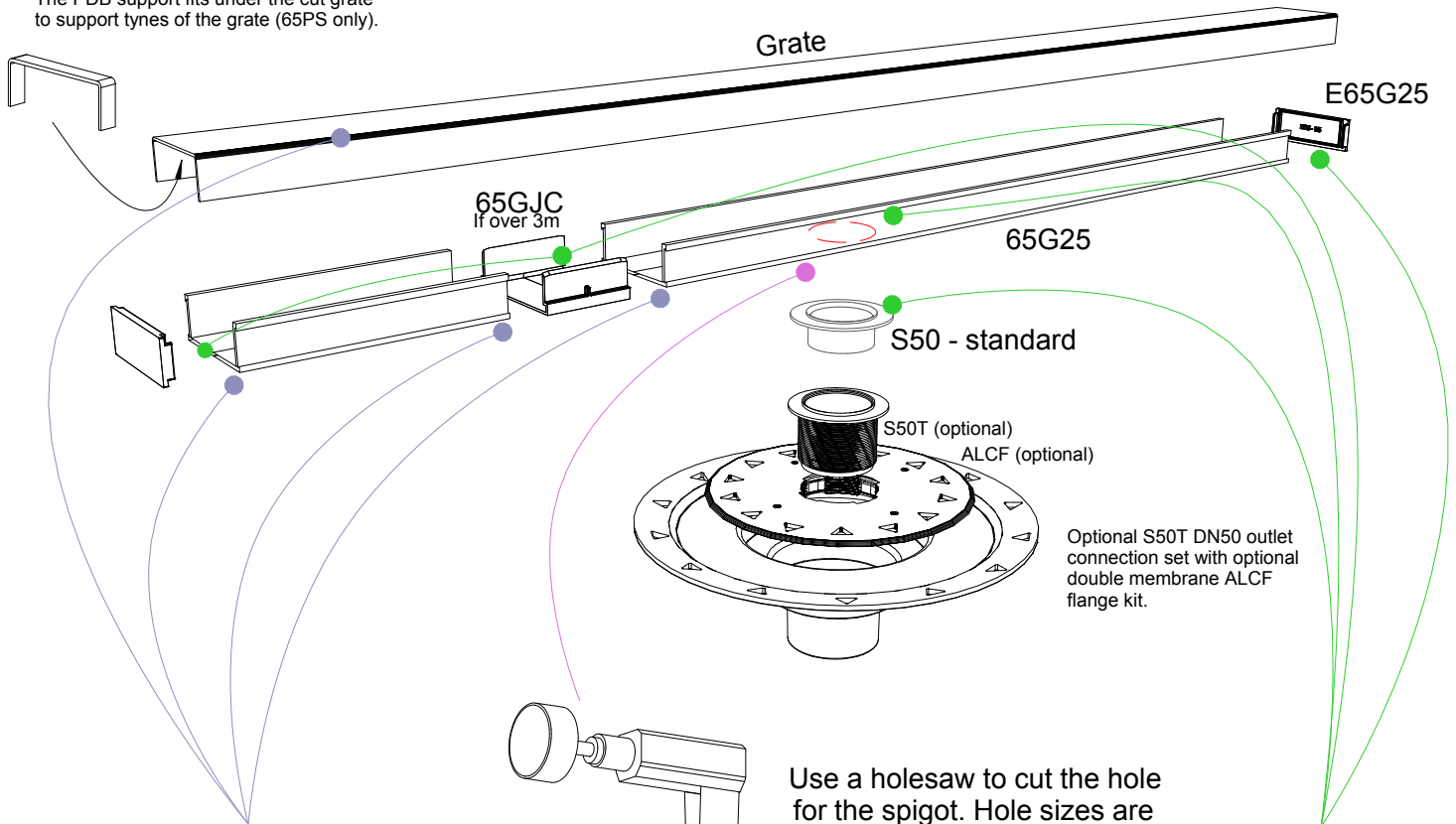

Optional S50T DN50 outlet connection set with optional double membrane ALCF flange kit.

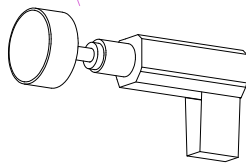

Use a holesaw to cut the hole for the spigot. Hole sizes are per below:
 51mm holesaw for S50 spigot to 50mm DWV pipe
 37mm holesaw for S40 spigot to 40mm DWV pipe

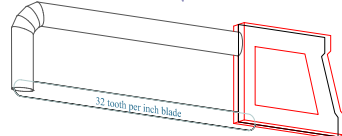

Use a hacksaw with 32TPI blade to cut both stainless grate and PVC channel. **NOTE, cut the GRATE AFTER the CHANNEL is ASSEMBLED. The GRATE will be SHORTER to fit INSIDE the channel.**

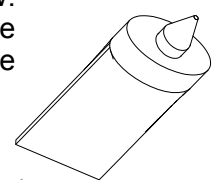

PVC solvent cement the parts together. Use type N clear with clear primer.

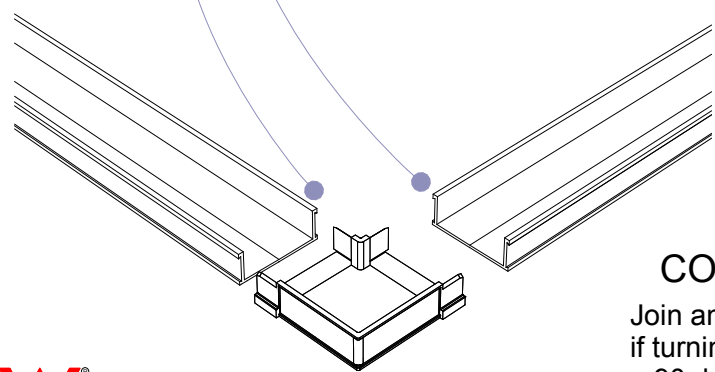

65GAM

CORNERS

Join angles as shown if turning channel around a 90 degree corner.

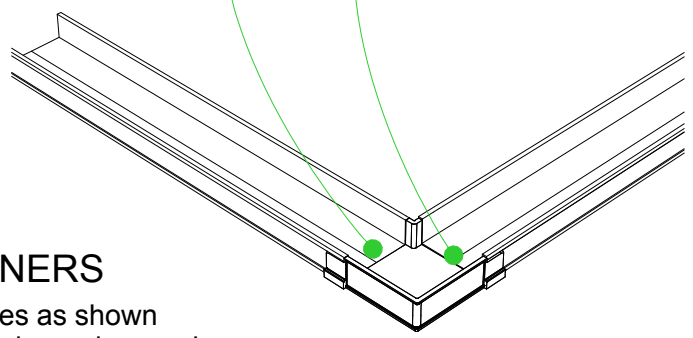

65G25 Bathroom

For 65ARG25, 65MNDG25, 65PHG25, 65PSG25, 65TRG25, and 65TRTiG25.

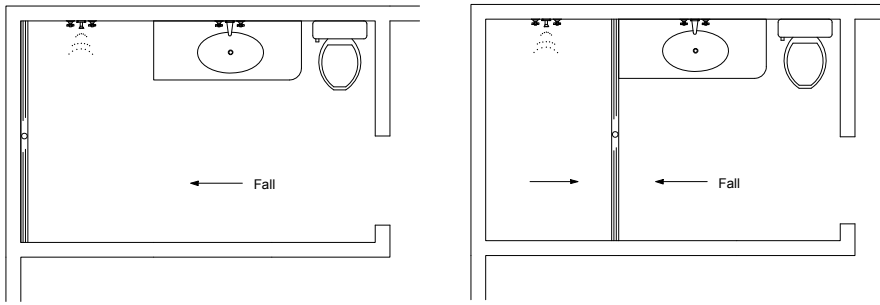

NOTE, refer to AS3500 for specific outlet pipe sizes related to your specific installation.

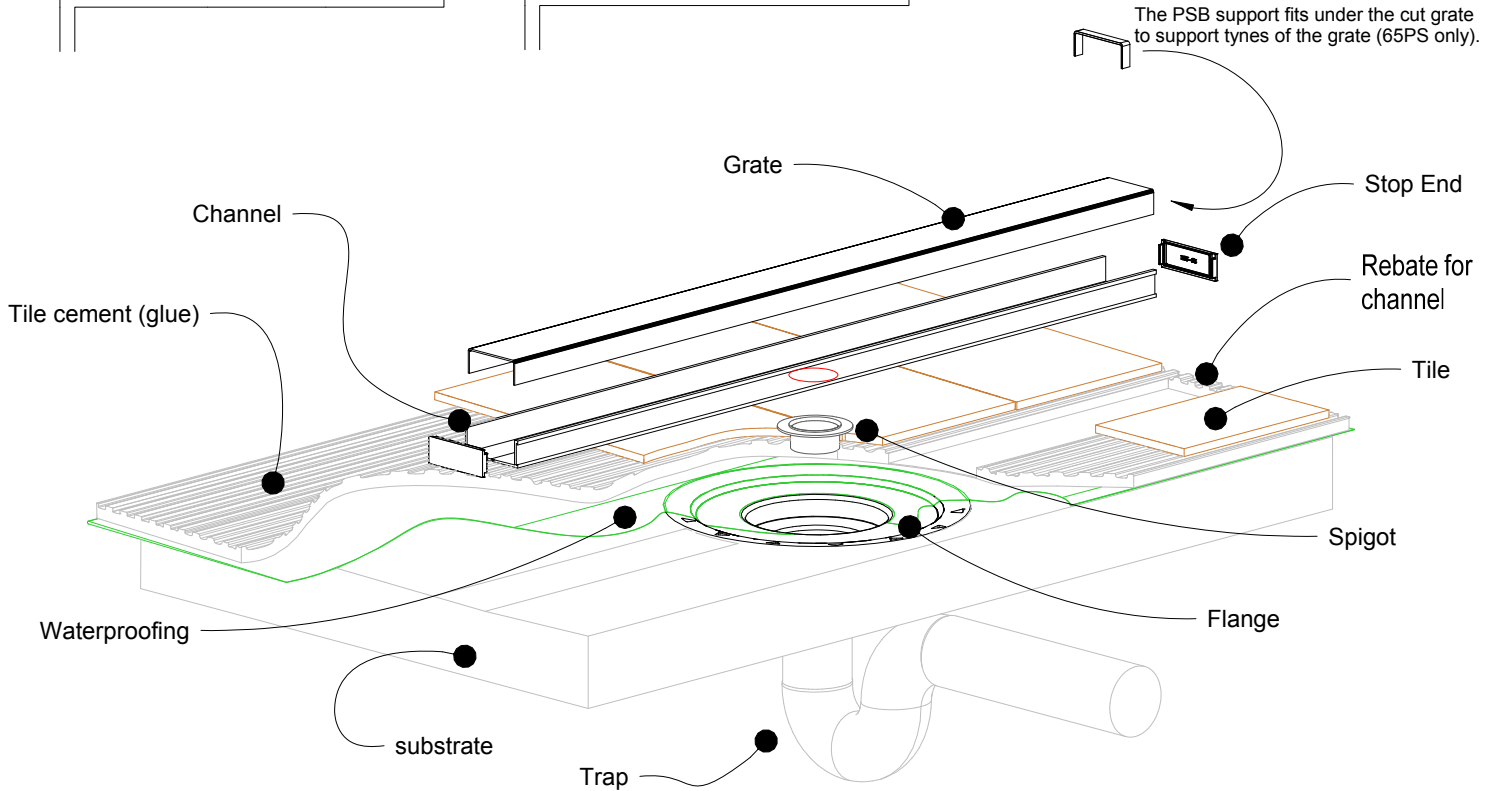

NOTE, this method requires the channel system to be ABOVE and SEPARATE from the WATERPROOFING.

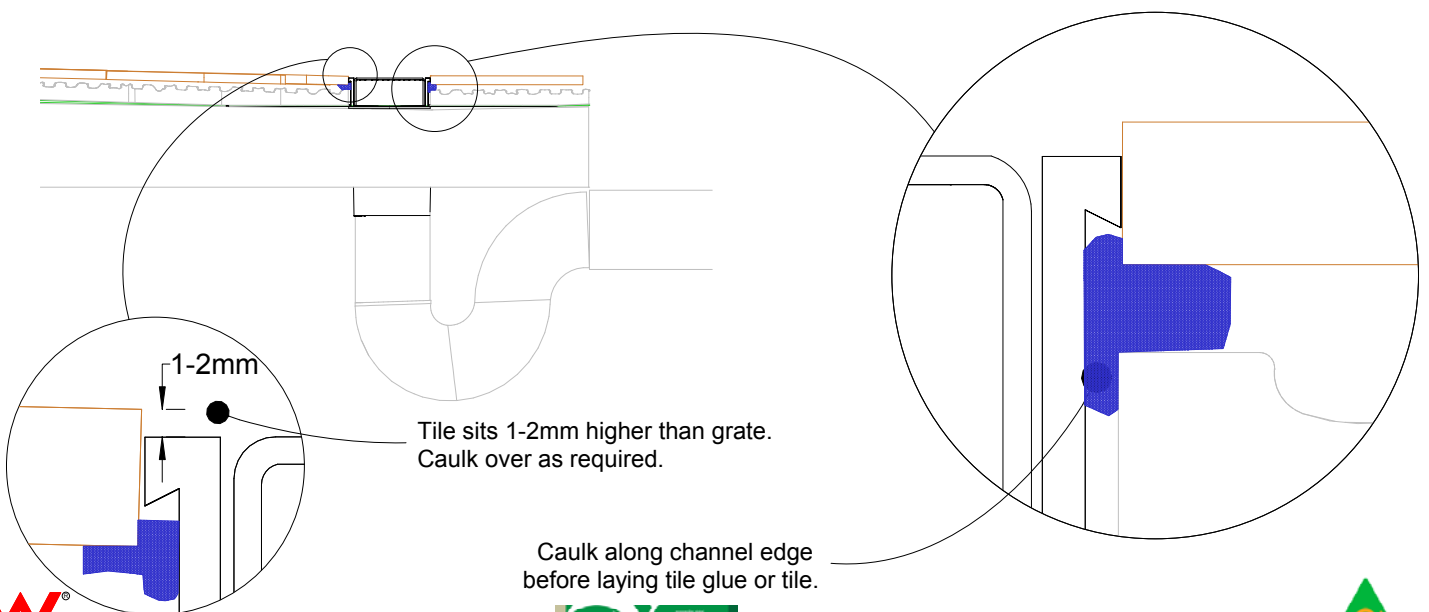

65G25 Concrete Floor or Deck

For 65ARG25, 65MNDG25, 65PHG25, 65PSG25, 65TRG25, and 65TRTiG25.



Slab on Ground

Waterproofing is fixed to the floor flange

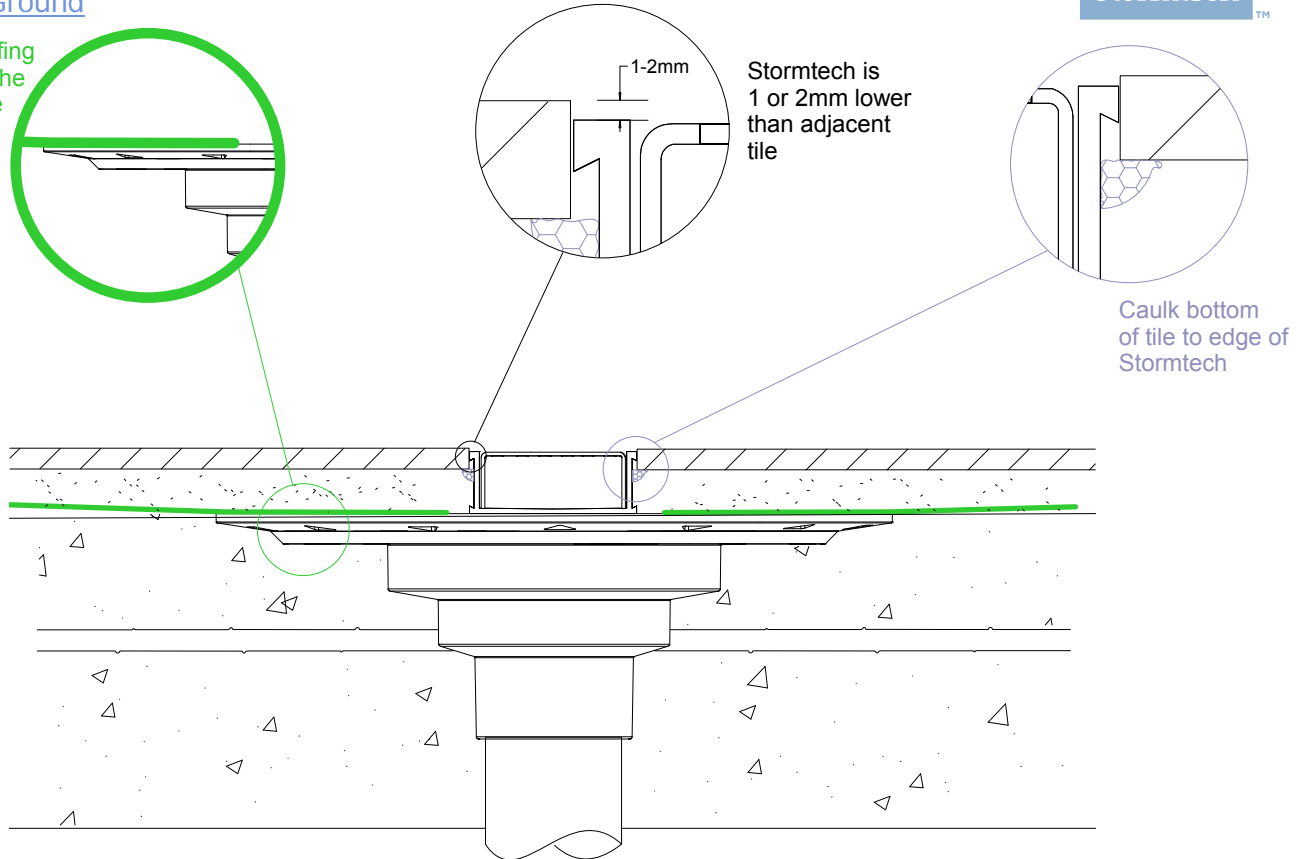

Suspended Slab

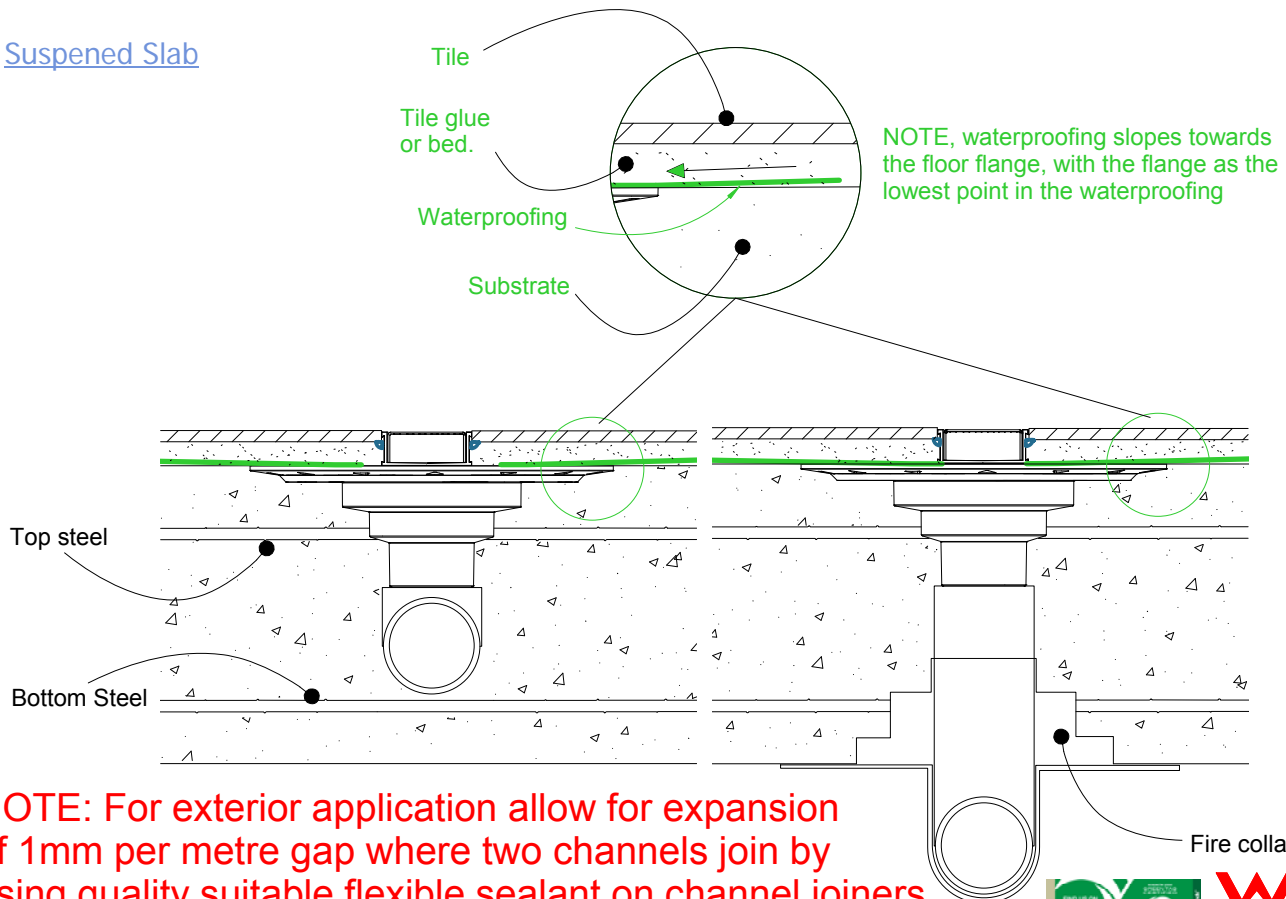

NOTE: For exterior application allow for expansion of 1mm per metre gap where two channels join by using quality suitable flexible sealant on channel joiners. Use PVC solvent cement for ends and outlets.



65G25 Off-Set Corners



When assembling channel for corners other than 90 degrees, the following fittings and method is suggested.

1

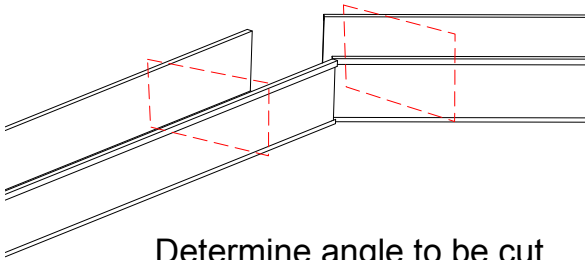

Determine angle to be cut

2

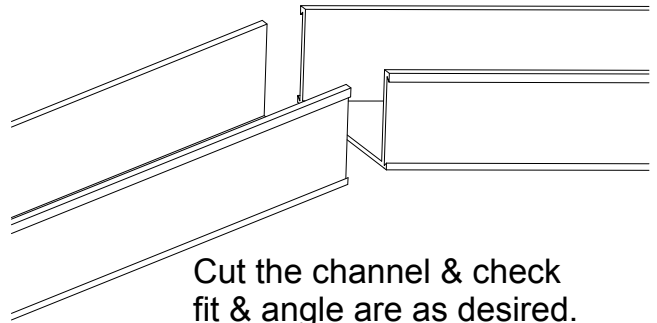

Cut the channel & check fit & angle are as desired.

3

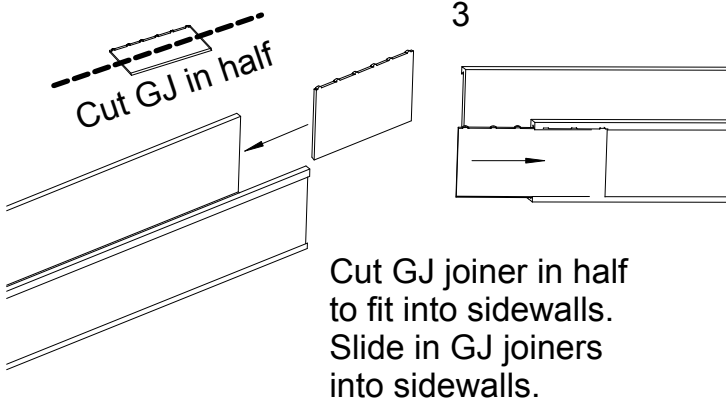

Cut GJ joiner in half to fit into sidewalls. Slide in GJ joiners into sidewalls.

4

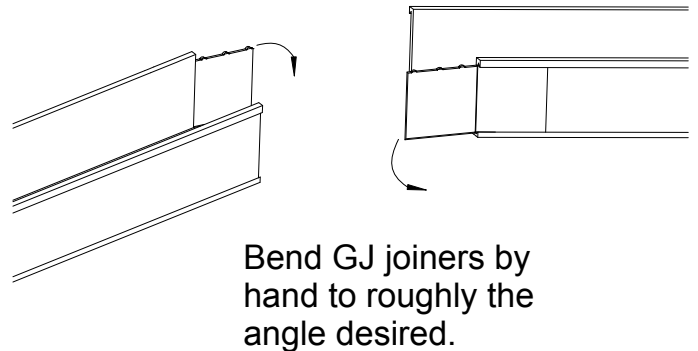

Bend GJ joiners by hand to roughly the angle desired.

5

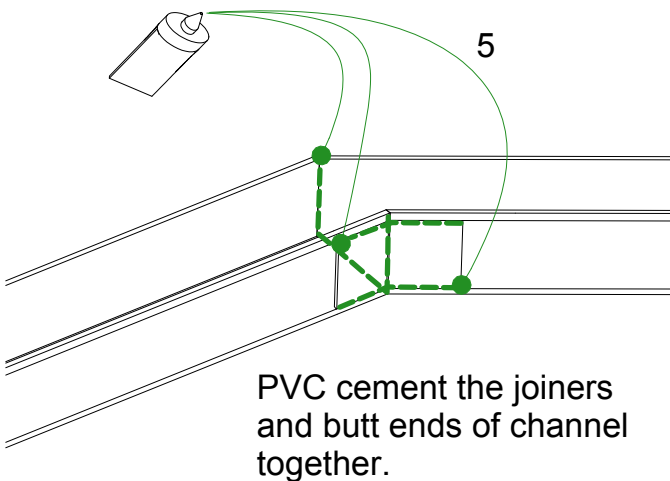

PVC cement the joiners and butt ends of channel together.

6

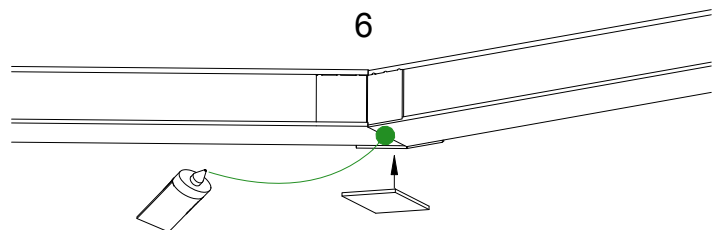

Fix an off-cut of channel to underside to brace join. Seal with adhesive sealant if join is uneven.



65G25 Threshold installation suggestion

For 65ARG25, 65MNDG25, 65PHG25, 65PSG25, 65TRG25, and 65TRTiG25.



Standard hinged door

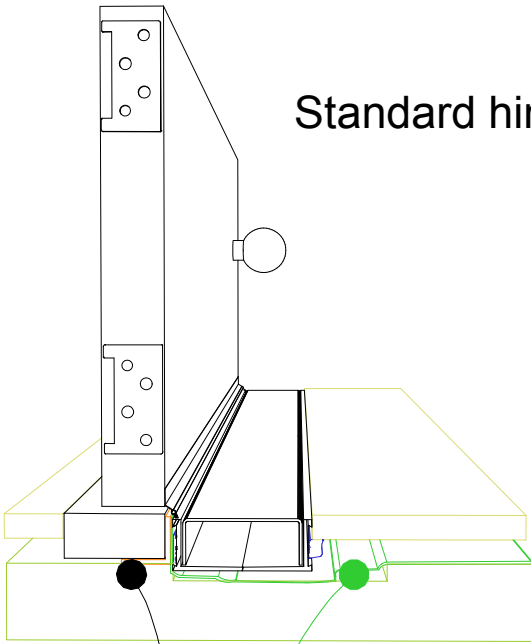

Aluminium angle to support waterproofing and junction between channel and door sil.

Top hung slider

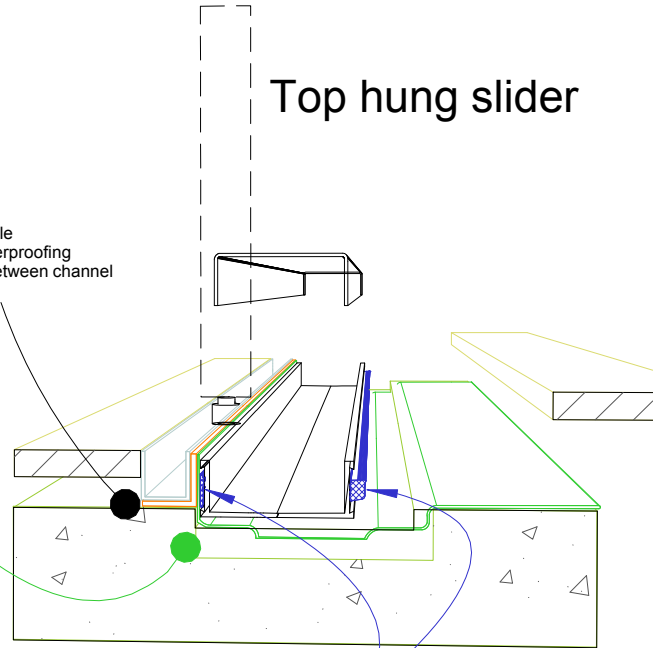

Aluminium angle to support waterproofing and junction between channel and door track.

Waterproofing

Bi-fold door

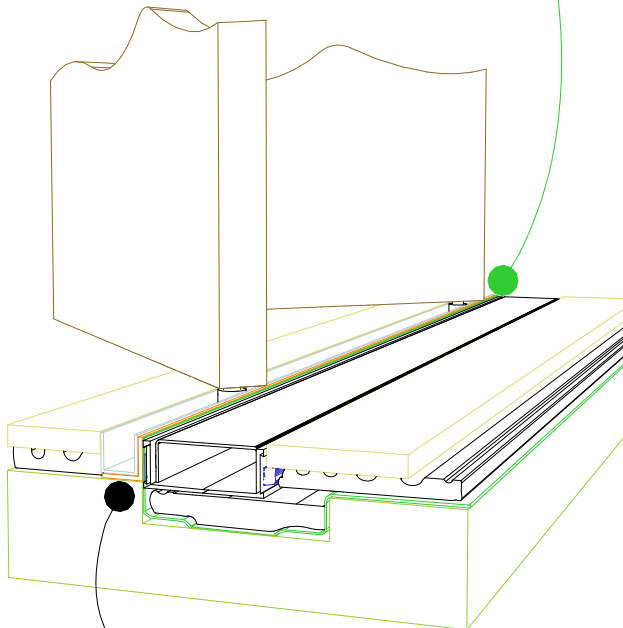

Aluminium angle to support waterproofing and junction between channel and door track.

For all types of threshold installation ensure both sides of the channel are sealed before laying tile.

NOTE, ALWAYS ensure the waterproofing is completed before laying the Stormtech.

NOTE, ensure weather strip is used on the appropriate side of the door to ensure drafts and moisture are minimised.



65G25 TIMBER FLOOR/DECK

For 65ARG25, 65MNDG25, 65PHG25, 65PSG25, 65TRG25, and 65TRTiG25.



When 65G25 is running parallel to joist/bearer

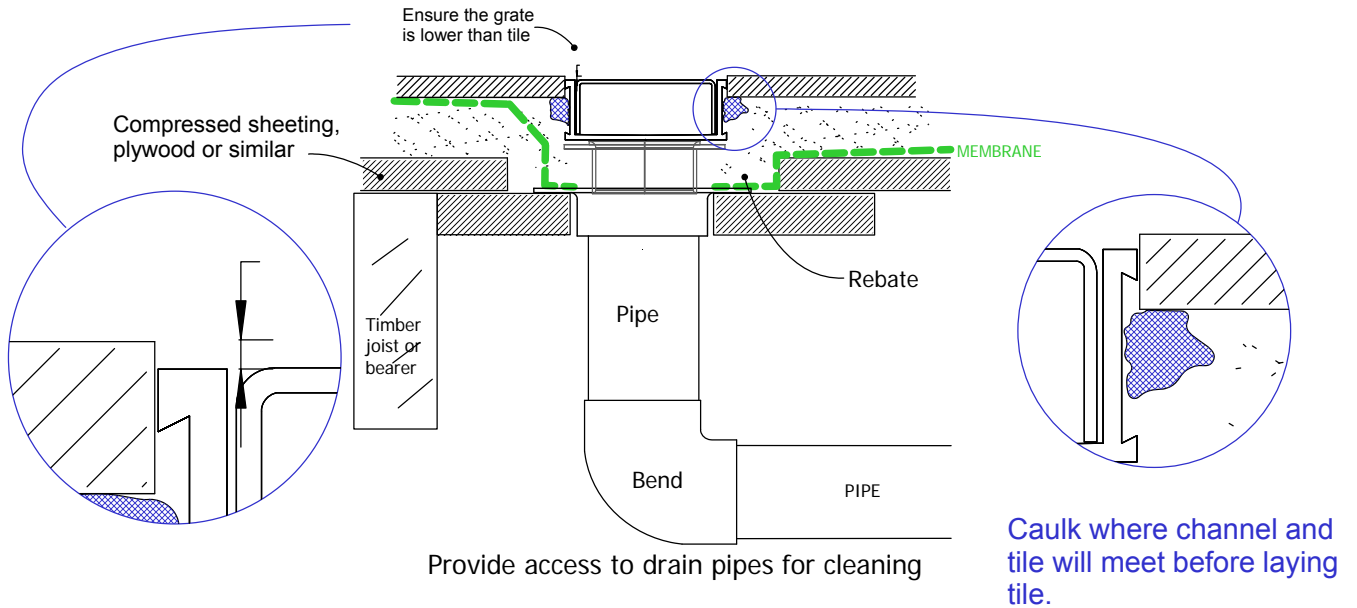

When 65G25 is running perpendicular to joist/bearer

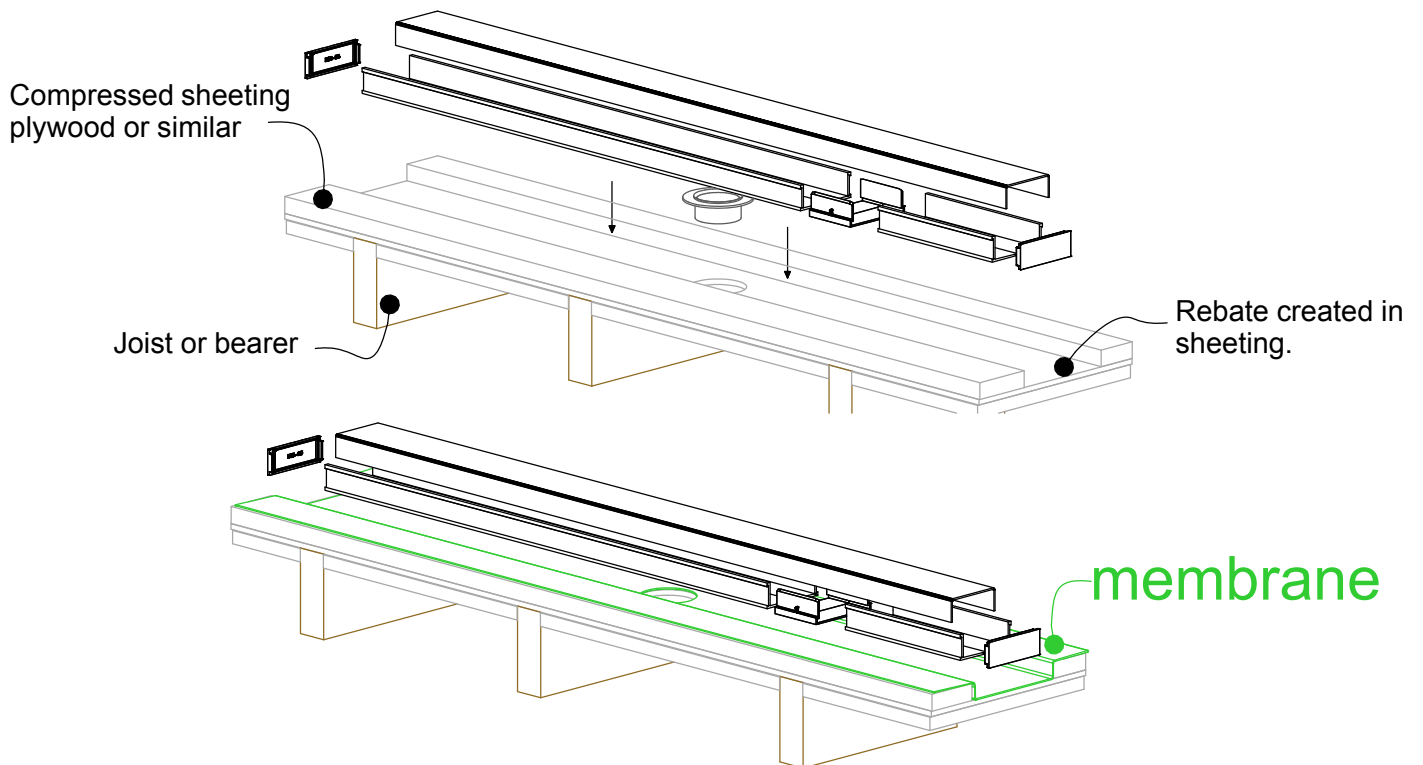

NOTE: For exterior application allow for expansion of 1mm per metre by using quality suitable flexible sealant on channel joints. Use PVC solvent cement and primer for ends and outlets.



Visit slimlinedrain.co.uk

